

## HIGH POWER DIODE LASER

*ALC-980-18000-FB*

The F-mount is an ideal component for quick prototyping and laboratory setups.

### Applications

- Pumping Yb Fiber Laser
- Medical
- Material Processing

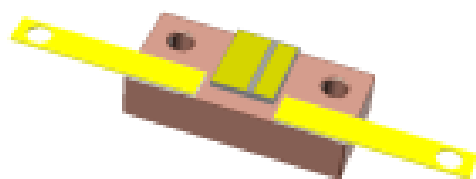

### Specifications

Optical Parameters	Units	
Center Wavelength	nm	976
Wavelength Tolerance	nm	±3
Spectral Width (FWHM)	nm	3.0
Wavelength Temp. Coefficient	nm/°C	0.3
Output Power	W	18.0
Operating Current	A	18.0
Operating Voltage	V	<2.0
Threshold Current	mA	1050
Emitter width	μm	190
Beam divergence fast axis, 95%	degrees	58
Beam divergence slow axis, 95%	degrees	11.5

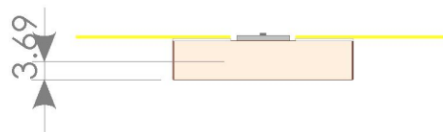
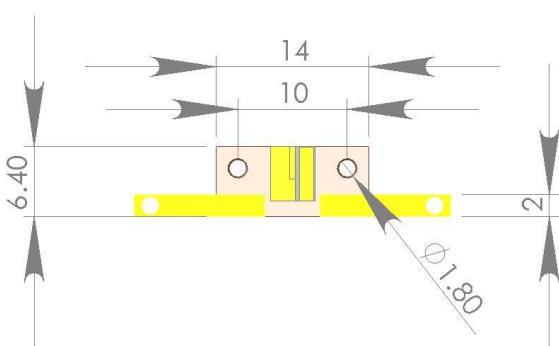

These components do not comply with the Federal Regulations (21 CFR Subchapter 1) as administered by the Center for Devices and Radiological health.

Purchaser acknowledges that his/her products must comply with these regulations before they can be sold.

Akela laser Corporation reserves right to change any specifications.