

HIGH POWER DIODE LASER

ALC-650-1000-FB

The F-mount is an ideal component for quick prototyping and laboratory setups.

Applications

- Medical
- Cr:LiSAF and Cr:LiCAF Solid State Laser Pumping

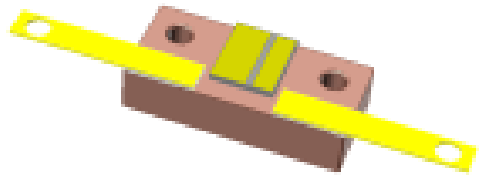

Specifications

Optical Parameters	Units	
Center Wavelength	nm	650
Wavelength Tolerance	nm	±5
Spectral Width (FWHM)	nm	1.0
Wavelength Temp. Coefficient	nm/°C	0.4
Output Power	mW	>1000
Operating Current	mA	1700
Operating Voltage	V	<2.2
Threshold Current	mA	700
Emitter width	μm	150
Beam divergence fast axis, FWHM	degrees	40
Beam divergence slow axis, FWHM	degrees	7

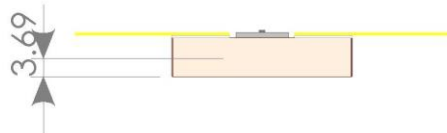
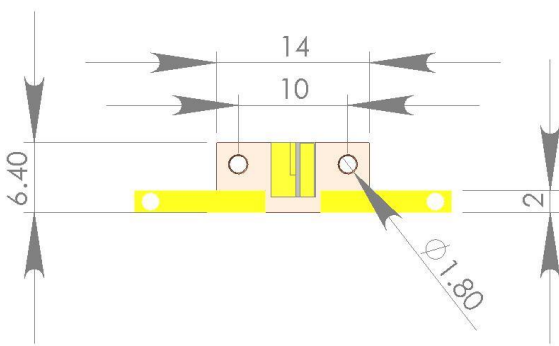
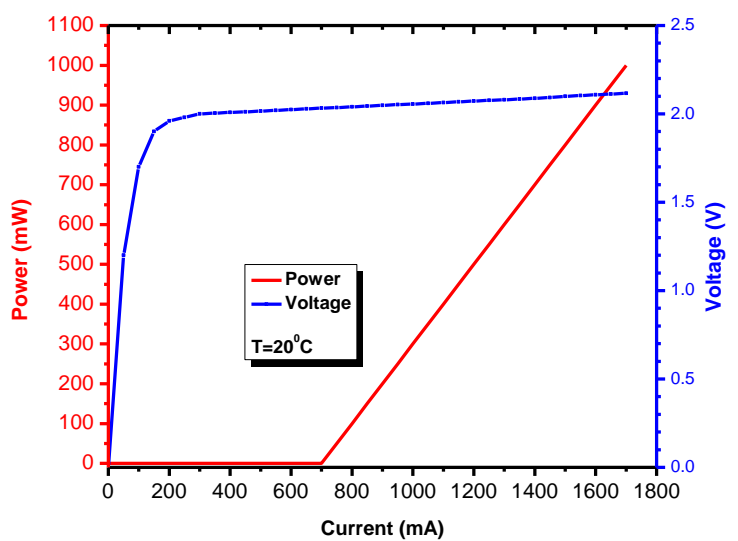

These components do not comply with the Federal Regulations (21 CFR Subchapter 1) as administered by the Center for Devices and Radiological health.

Purchaser acknowledges that his/her products must comply with these regulations before they can be sold.

Akela laser Corporation reserves right to change any specifications.