

HIGH POWER DIODE LASER

ALC-1907-00750-FB

The F-mount is an ideal component for quick prototyping and laboratory setups.

Applications

- Medical
- Material Processing
- Pumping Ho Solid State Laser

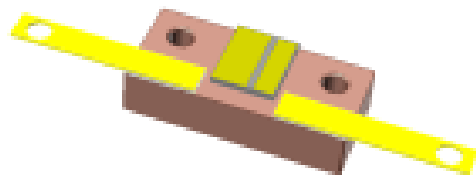

Specifications

Optical Parameters	Units	
Center Wavelength	nm	1907
Wavelength Tolerance	nm	±10
Spectral Width (FWHM)	nm	<12.0
Wavelength Temp. Coefficient	nm/°C	0.5
Output Power	mW	750
Operating Current	A	5
Operating Voltage	V	<1.4
Threshold Current	A	1.2
Emitter width	μm	150
Beam divergence fast axis, FWHM	degrees	44
Beam divergence slow axis, FWHM	degrees	12

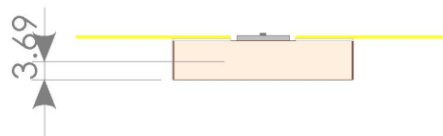
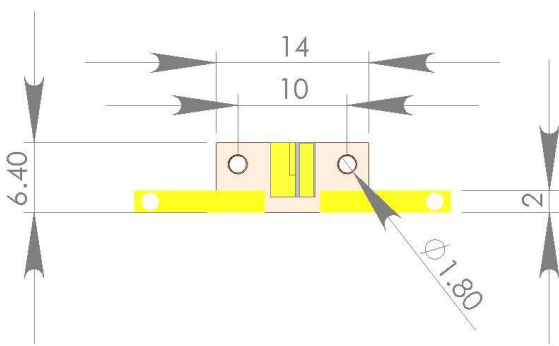
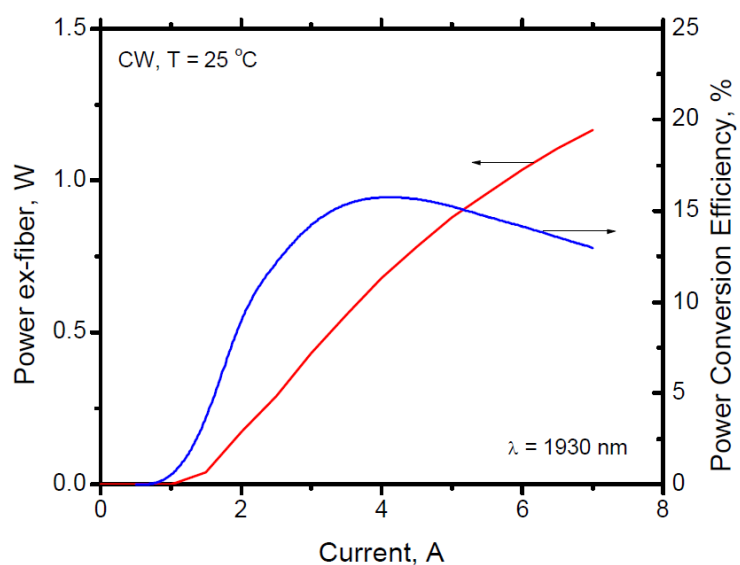

These components do not comply with the Federal Regulations (21 CFR Subchapter 1) as administered by the Center for Devices and Radiological health.

Purchaser acknowledges that his/her products must comply with these regulations before they can be sold.

Akela laser Corporation reserves right to change any specifications.