

HIGH POWER DIODE LASER

ALC-1370-4500-FB

The F-mount is an ideal component for quick prototyping and laboratory setups.

Applications

- Medical
- Material Processing

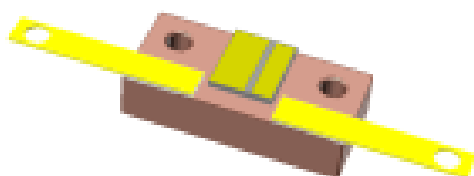

Specifications

Optical Parameters	Units	
Center Wavelength	nm	1370
Wavelength Tolerance	nm	±10
Spectral Width (FWHM)	nm	10.0
Wavelength Temp. Coefficient	nm/°C	0.5
Output Power	W	>4.5
Operating Current	A	9
Operating Voltage	V	<1.5
Threshold Current	A	0.7
Emitter width	µm	100
Beam divergence fast axis, FWHM	degrees	34
Beam divergence slow axis, FWHM	degrees	8

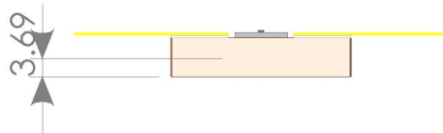
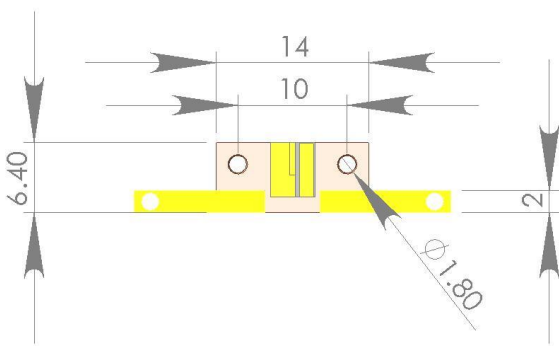
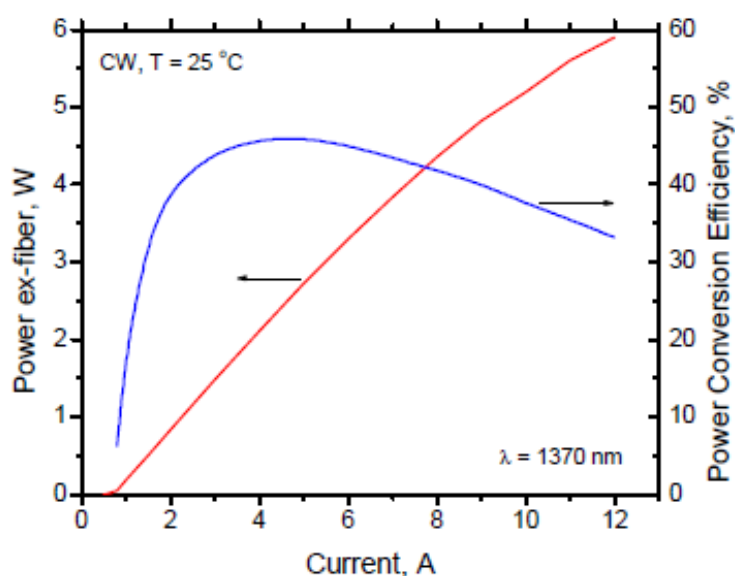

These components do not comply with the Federal Regulations (21 CFR Subchapter 1) as administered by the Center for Devices and Radiological health.

Purchaser acknowledges that his/her products must comply with these regulations before they can be sold.

Akela laser Corporation reserves right to change any specifications.